

Doorskin lines

01 | 2010



Performance

- Dieffenbacher offers a state of the art technology for moulded doorskin industry: A complete production unit from wood yard to doorskin storage.
 - The moulded doorskins are manufactured from log or/and wood chips as raw material. The wood is refined, resinated and dried in the same manner as in MDF/HDF manufacturing. The multi opening press is however designated for this product. Due to the high pressure and short cycle time the press must be designed to withstand the wear year after year.
 - The panel handling after the press is designed to handle the sensitive surface in the most gentle way.

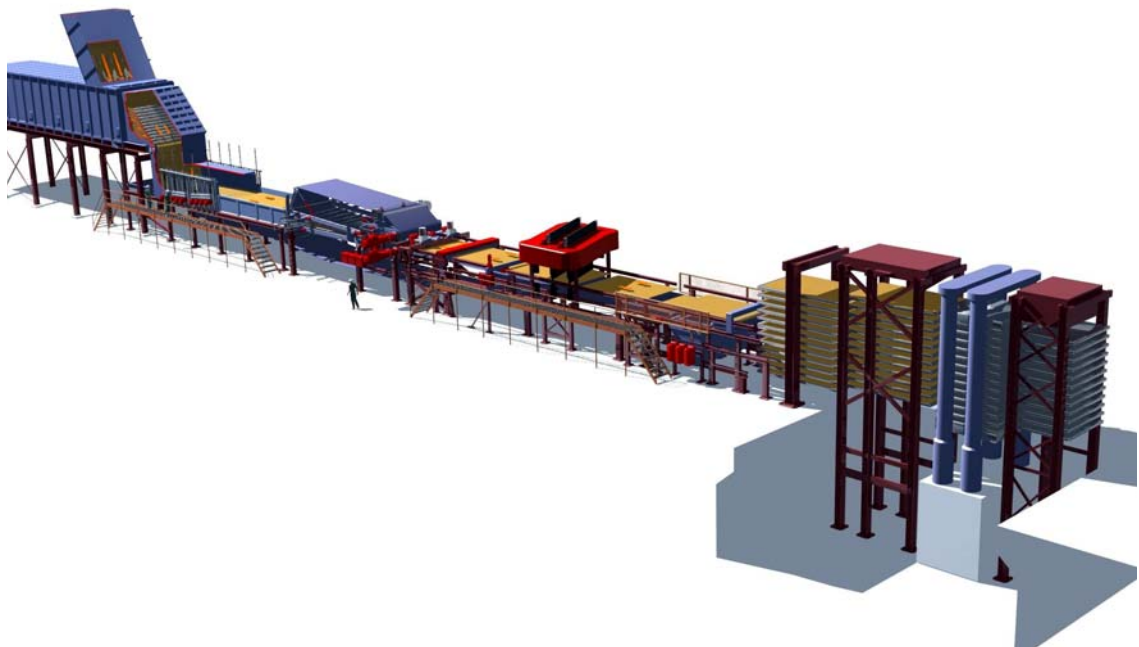

Your benefits

■ Benefits:

- The unique pre-tensioned press columns avoid fatigue cracks. Proven in numerous installations.
- Extremely fast press die change minimizes downtime.
- Accurate sawing after press with a minimum of waste.
- Two-stage dryer concept with high-efficiency energy plant guarantees a low energy consumption.

■ Typical design criteria:

- Refiner capacity 9 ton/h (B.D.)
- Dryer exit moisture 10%
- Forming line speed 35 m/min
- Press cycle time 55 seconds
- doorskin density 1,050 kg/m³
- Final door moisture 3 – 5%
- Two doorskins per press opening
- Capacity 9,504.00 skins/year (10 openings at press, press cycle time 55 s)